

FEATURES/CARATTERISTICHE

| | |
|---|--------------------------------|
| Materials available/Materiali disponibili: | PP; PVDF |
| Max flow/Portata massima: | 25 m ³ /h |
| Max head/Prevalenza massima: | 22.5 m |
| Max temperature/Temperatura massima: | PP 60°C; PVDF 90°C |
| Max viscosity/Viscosità massima: | 20 cSt |
| Pressure rating/Pressione nominale massima: | NP/PN 6 @ 20°C |
| Pump weight/Peso pompa: | PP: 15 Kg; PVDF: 20 Kg |
| Motor weight/Peso motore (approx.): | 3.0 kW: 23 Kg 4.0 kW: 31 Kg |

CURVES/CURVE 50HZ-2900 RPM

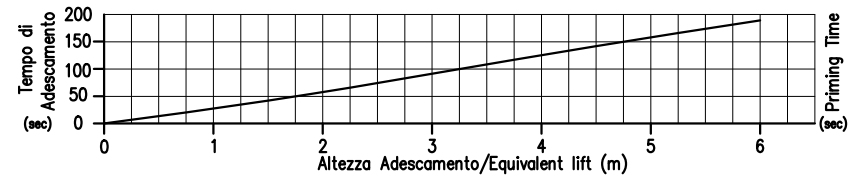
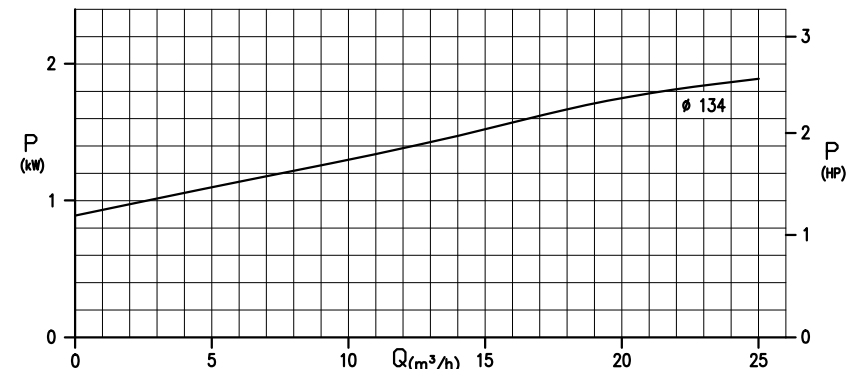
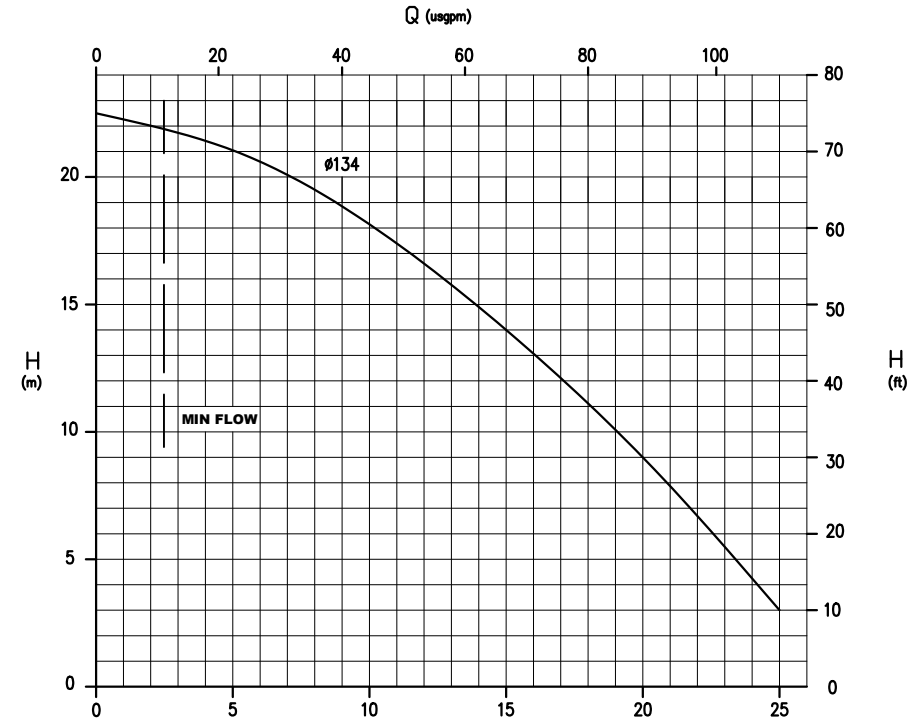

SECTION AND PARTS LIST/SEZIONE E LISTA PARTI

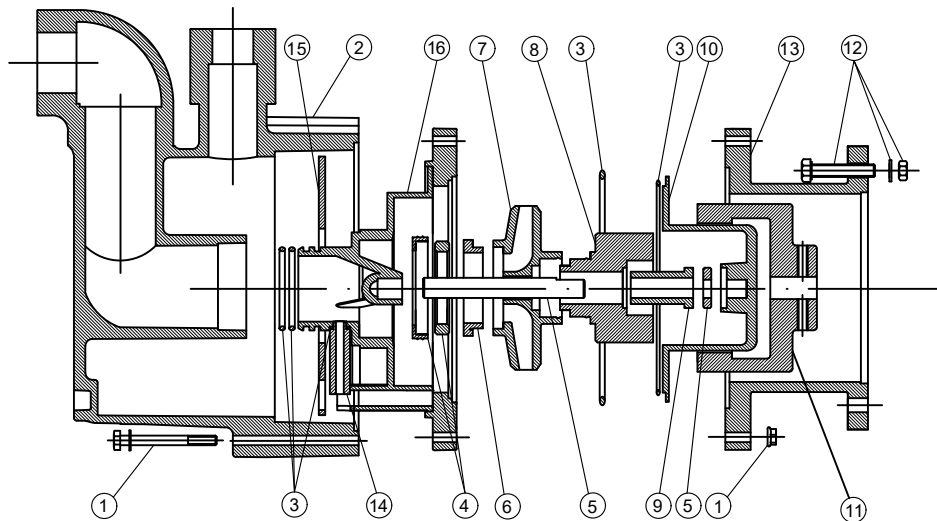

| 1 | 2 | 3 | 4 | 5 | 6 | 7 | 8 | 9 | 10 | 11 | 12 | 13 | 14 | 15 | 16 |
|------------|--------------|------------|--------------------|--------------|-------------------------|----------|---------------|---------|-------------|-------------|------------|---------|-----------------|------|-----------------|
| SET SCREWS | PUMP HOUSING | O-RING | CASING THRUST BUSH | SHAFT+ RING | IMPELLER THRUST BEARING | IMPELLER | INT. MAGNET | BEARING | REAR CASING | EXT. MAGNET | SET SCREWS | BRACKET | VENTURI CONNECT | DISC | INTERIOR CASING |
| AISI304 | PP | EPDM/VITON | Al2O3(99.7%) EPDM | Al2O3(99.7%) | PTFEC | PP/PVDF | PP/PVDF NdFeB | PTFEC | PP/PVDF | CS NdFeB | AISI304 | PP | PP/PVDF | PP | PP/PVDF |